

光影.流.岸 FLUID LIGHT STRIPES

本建筑的主要设计主题为“光影.流.岸”，旨在通过建筑的形式和空间，表达一种“流动”和“光影”的概念。建筑的设计灵感来源于自然界的“流体”和“光影”现象，旨在通过建筑的形式和空间，表达一种“流动”和“光影”的概念。建筑的设计灵感来源于自然界的“流体”和“光影”现象，旨在通过建筑的形式和空间，表达一种“流动”和“光影”的概念。

The design of the Shanghai Theater Building (STB) of Lujiazui, Shanghai, China, is a masterpiece of modern architecture. It is a prime example of the "Fluid Light Stripes" concept, which is a blend of nature and technology. The building's design is inspired by the natural world, particularly the fluidity of water and the play of light and shadow. The building's form is a result of a series of iterative design processes, where the architects sought to create a structure that is both functional and aesthetically pleasing. The building's design is a testament to the power of architecture to create a sense of movement and light.

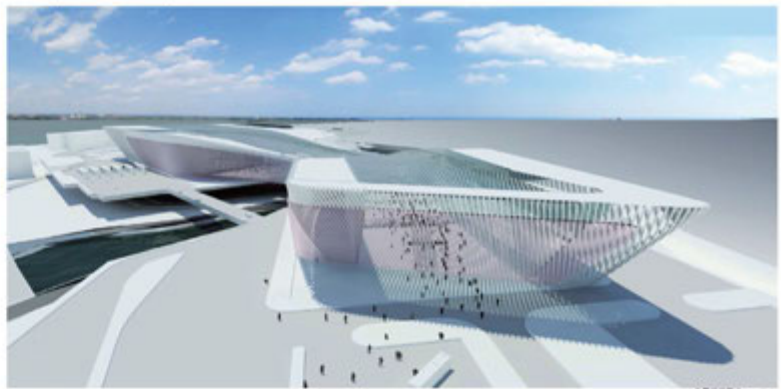
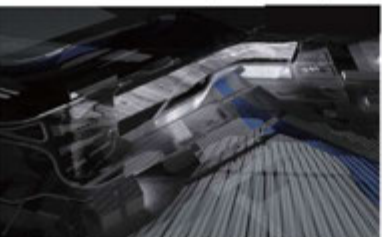
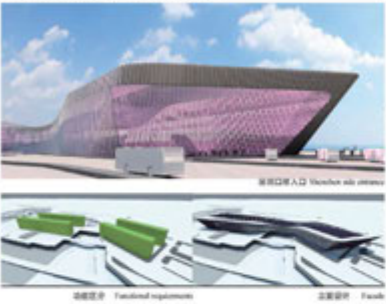

East Elevation 东立面透视图

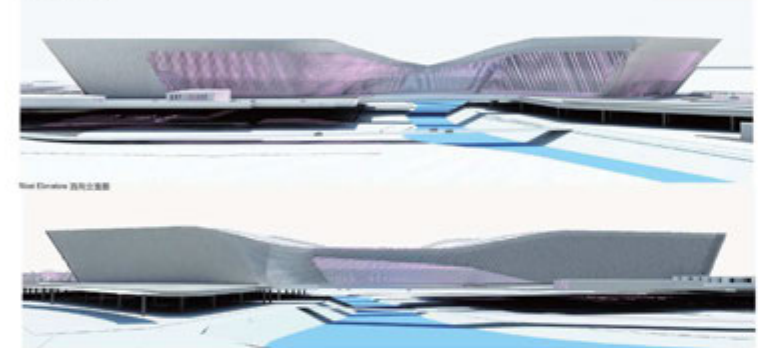

West Elevation 西立面透视图

